

## 14. Boom Head

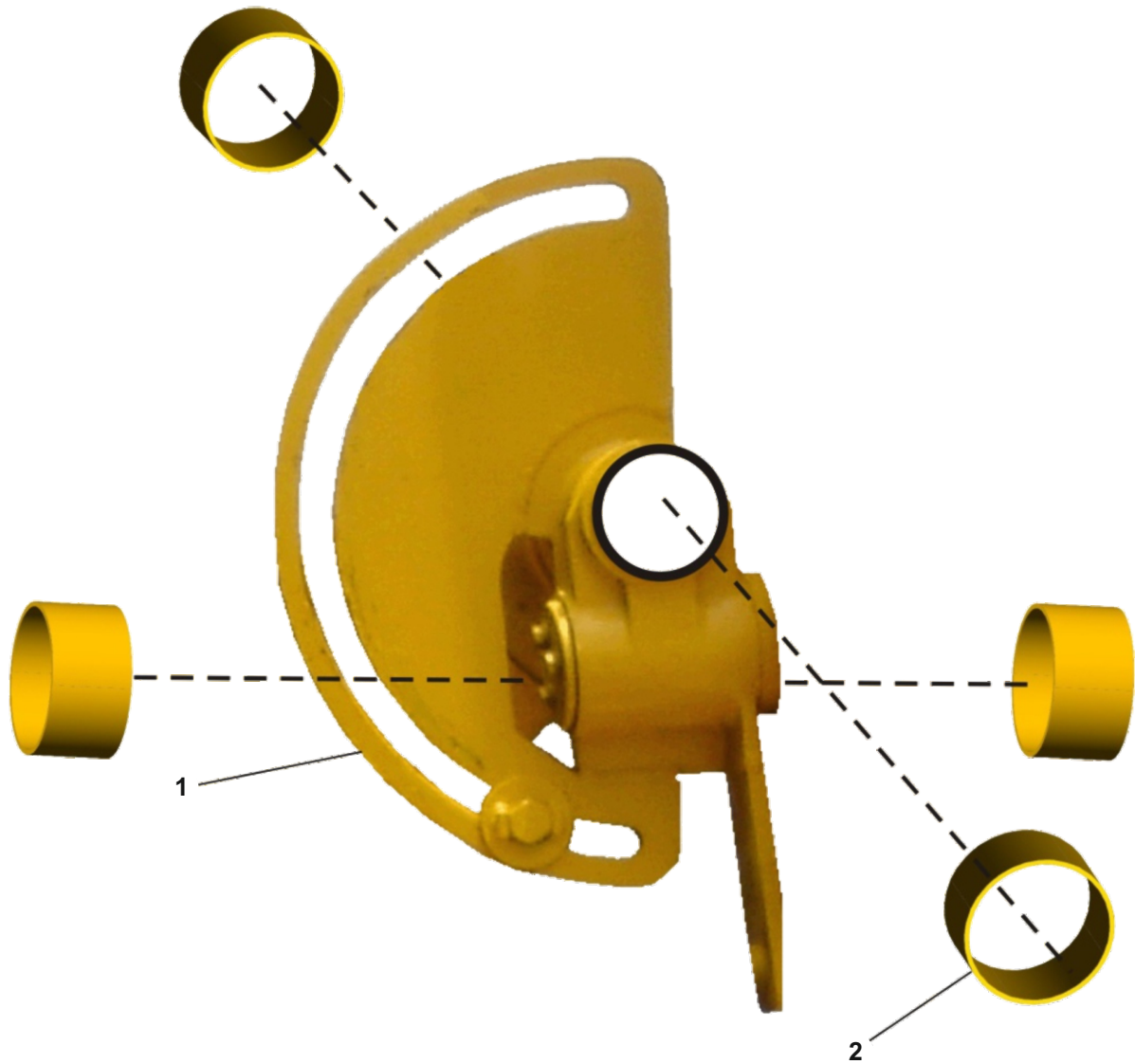

| No. | Description              | Modified | Ref. Part No. | QTY |
|-----|--------------------------|----------|---------------|-----|
| -   | Boom Head Complete (1-2) |          | 3217051280    | 1   |
| 1   | - Boom Head              |          |               | 1   |
| 2   | - Bushing                |          | 9718427100    | 4   |

Note : Reference Part Number Starting With 'M' - Is Modified.